

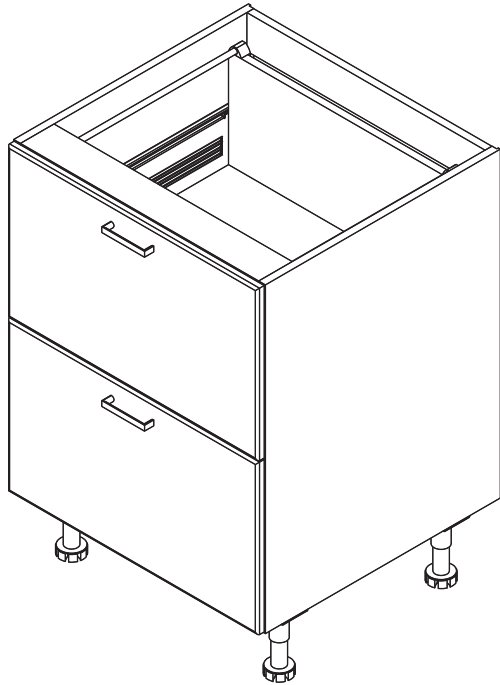

600mm 2 DRAWER FLOOR CUPBOARD

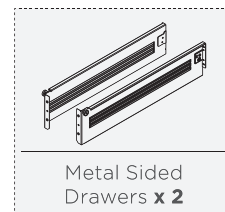

Hardware Included

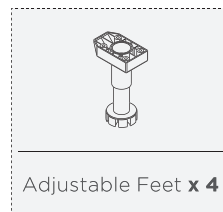
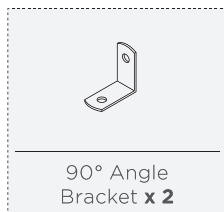
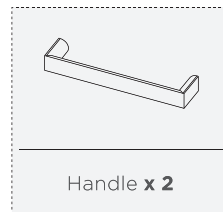
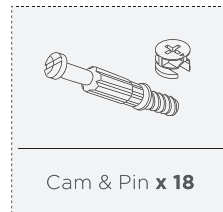

Tools you will need

To put your cabinets together you will need the following tools.

<p>Cordless drill with:</p> <ul style="list-style-type: none"> • Number 2 Phillips head bit • 4.5mm drill bit • Number 12 countersinking drill bit 	<p>Tape Measure</p>	<p>Pencil</p>	<p>Hammer</p>	<p>Clamps (Quick Release)</p>	<p>Safety Gear</p>	<p>Phillips Head Screw Driver</p>
<p>Spirit Level (900mm recommended)</p>	<p>Masking Tape</p>	<p>65mm Wood Screw</p>	<p>Wall Fixing (If Necessary)</p>			

Important notice

- Make sure you leave plumbing and electrical work to qualified trades people. Never try this yourself.
- If you have any questions contact us on **1800 666 078** Monday to Friday between 8:00am and 6:00pm AEST or email: info@flatpax.com.au.



STEP 1

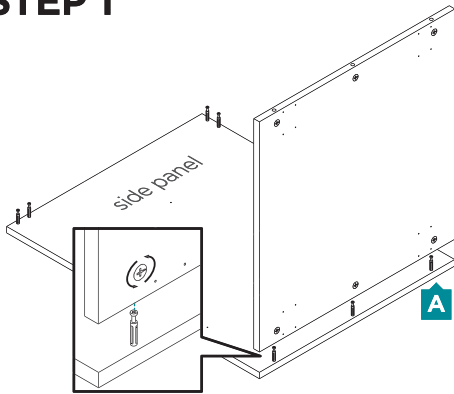

note: Make sure the pre-drilled holes for the adjustable feet are facing outwards.

STEP 2

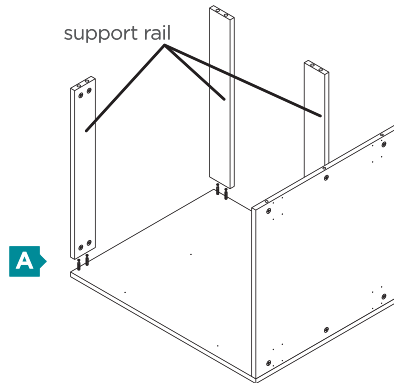

STEP 3

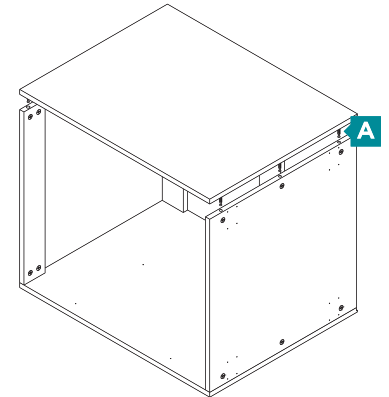

STEP 4

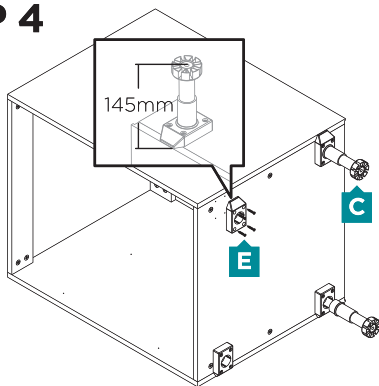

stop: If this cabinet is to be installed at the end of the run refer to the kickboard instructions now on the correct placement of the feet.
Set the height of the adjustable feet to 145mm to suit the kickboard.

STEP 5

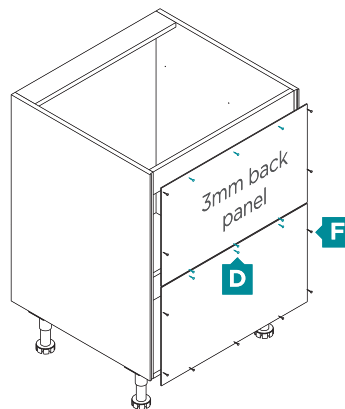

note: The white side of the back panel should face inside the cabinet.

STEP 6

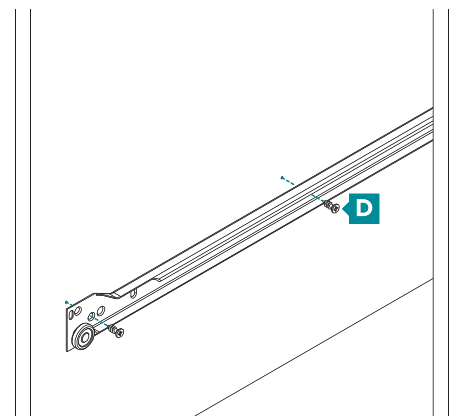

STEP 7

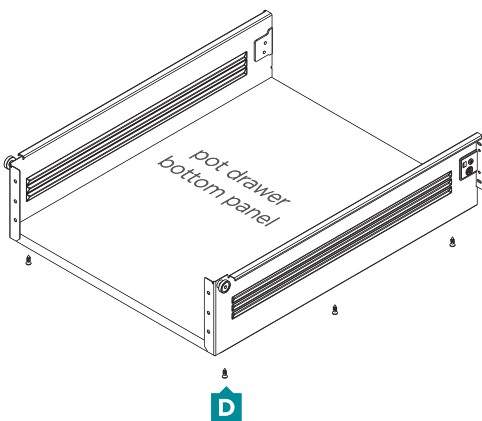

STEP 8

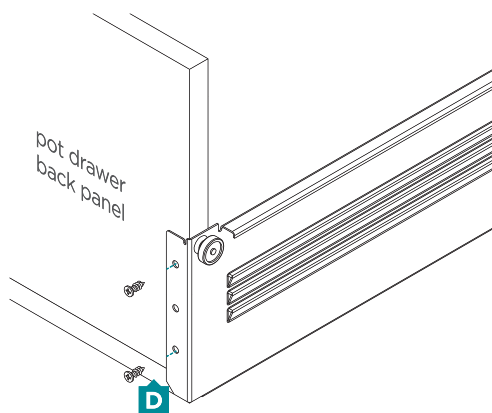

STEP 9

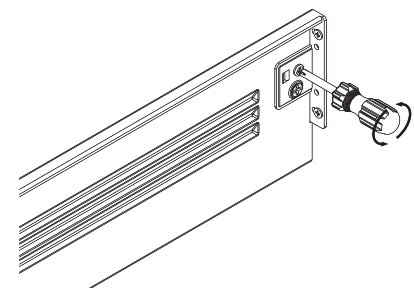

Remove bracket from metal sided drawer by releasing the screw.

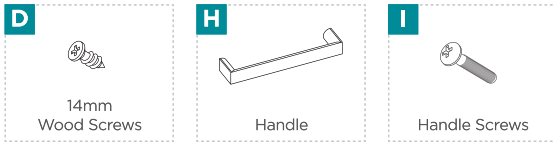

STEP 10

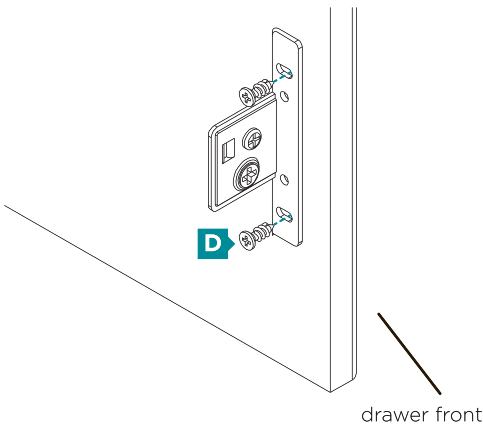

STEP 11

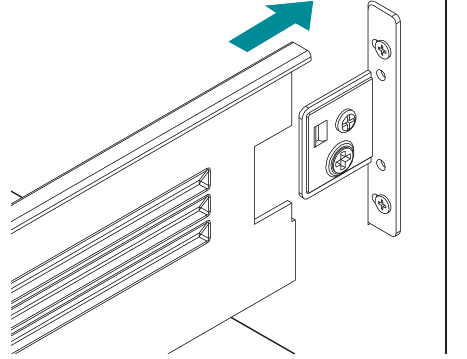

STEP 12

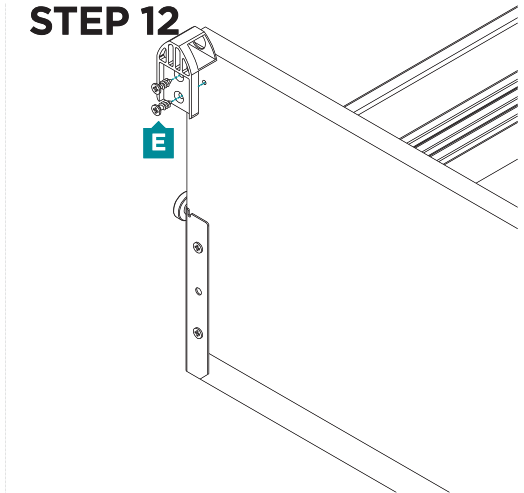

STEP 13

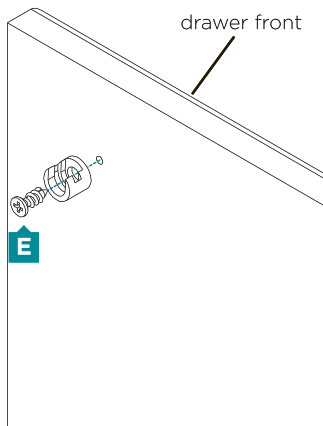

STEP 14

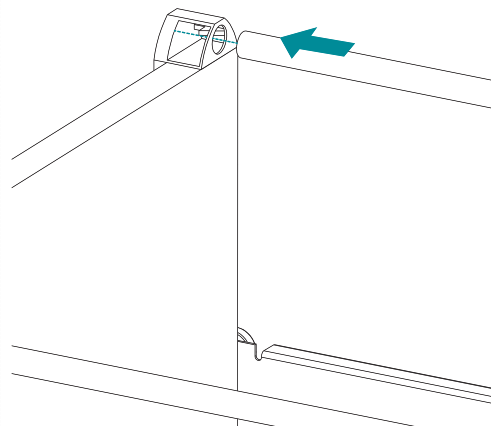

STEP 15

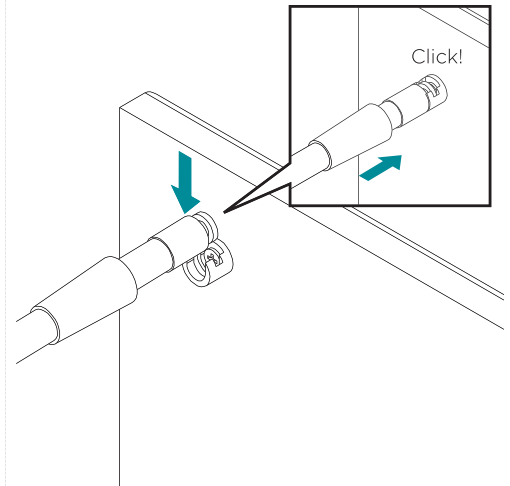

STEP 16

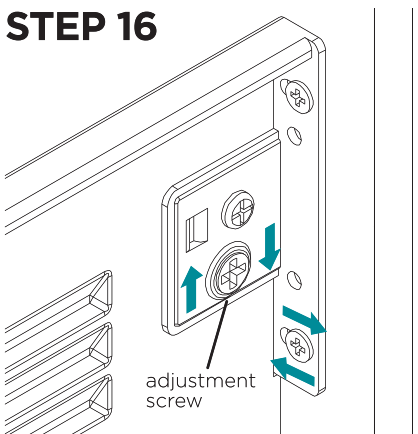

Drawer fronts can be adjusted up and down via the adjustment screw, and left and right via the elongated holes in the bracket.

STEP 17

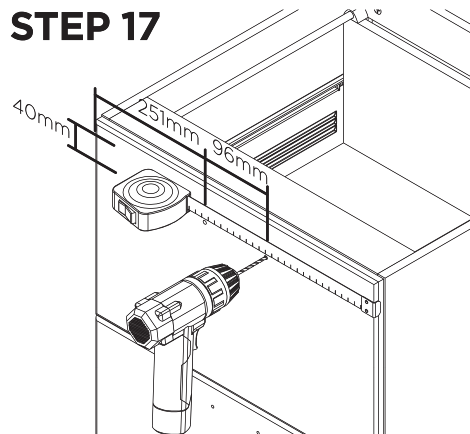

Place masking tape on both sides of the door where holes will be drilled to avoid chipping. Pre-drill using 4.5mm drill bit.

STEP 18

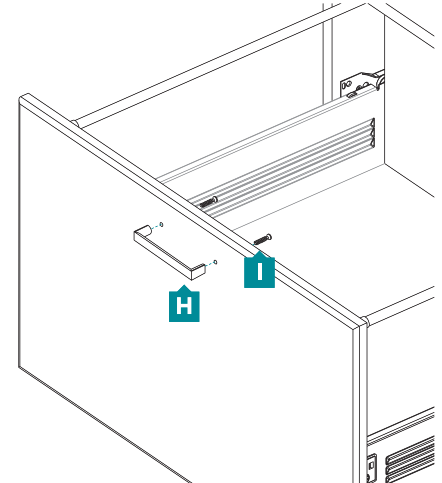

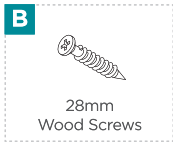

STEP 19

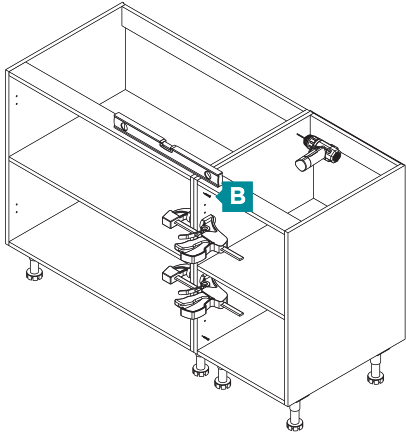

Check cabinets are level then clamp together.
Pre-drill using 2mm drill bit and attach cabinets together.

STEP 20

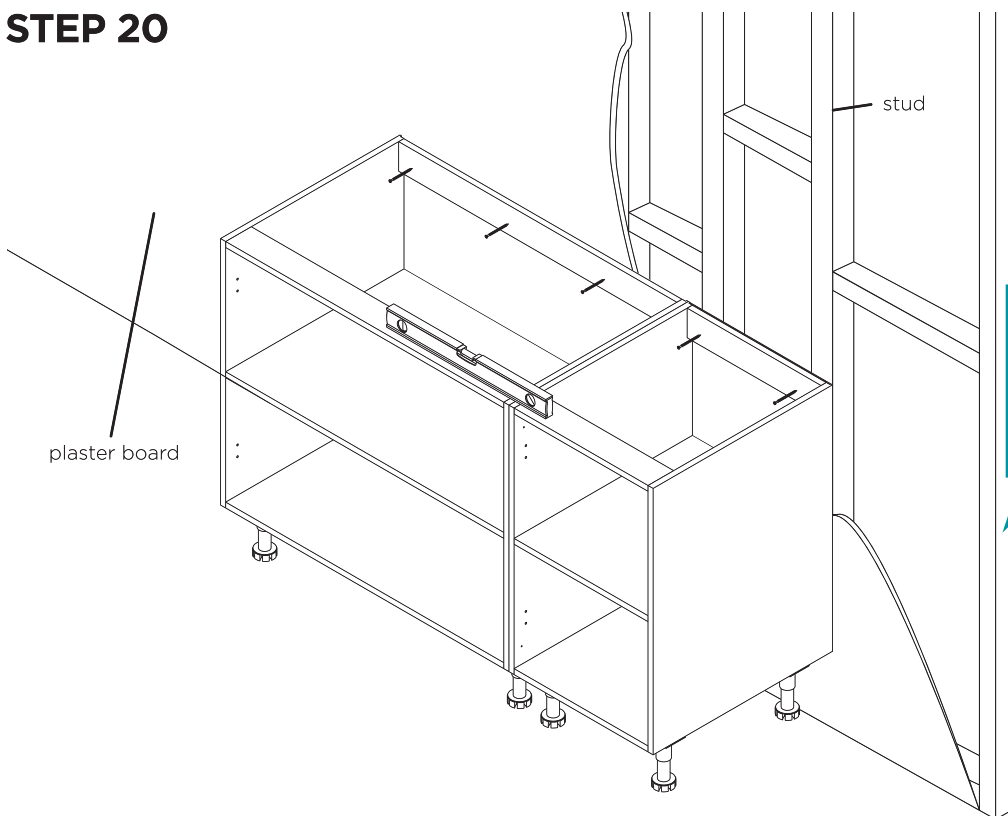

Caution: Please ensure all cabinets are screwed into your timber stud wall using a minimum of 65mm timber screws. If attaching to concrete, brick, steel or any other substrates seek advice from your hardware specialist.